

# COLLETS

## Sizes, adapters, and prices

**NOTE: A collet is needed for each different diameter electrode.** All collets fit into the Spindle Adapter, and are held secure by the Chuck Lock Nut. There are larger electrodes available. Sizes larger than .312 diameter come with a 2" shank that will adapt to the A1504 - 312 collet.

### COLLET SELECTION CHART

ELECTRODE DIAMETER	COLLET PART NUMBER
.020 For these sizes use a PIN VISE	
.030 (see below) with a .312 collet	
.040=1mm	A 1504 - 040
.050	A 1504 - 050
.060=1.5 mm	A 1504 - 060
.075	A 1504 - 075
.079=2mm	A 1504 - 079
.090	A 1504 - 090
.098=2.5 mm	A 1504 - 098
.110	A 1504 - 110
.118=3mm	A 1504 - 118
.125	A 1504 - 125
.140=3.5 mm	A 1504 - 140
.156=4mm	A 1504 - 156
.170	A 1504 - 170
.177=4.5 mm	A 1504 - 177
.187	A 1504 - 187
.200=5mm	A 1504 - 200
.218=5.5 mm	A 1504 - 218
.230	A 1504 - 230
.236=6mm	A 1504 - 236
.250	A 1504 - 250
.276=7mm	A 1504 - 276
.290	A 1504 - 290
.312=8mm	A 1504 - 312

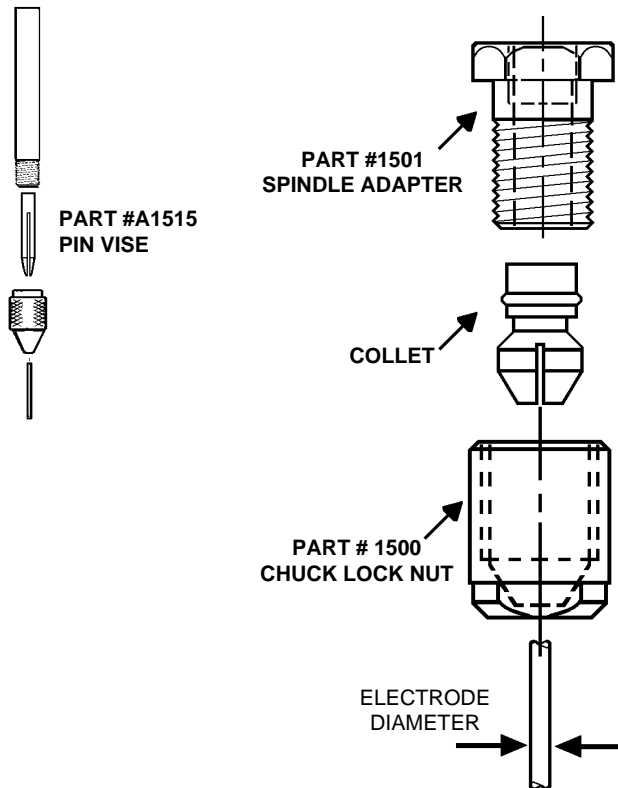

***Molybdenum electrodes are available in standard lengths of 6", 9" or 12".  
Special lengths are available.***

ELECTRO ARC electrodes are recommended for removing broken taps, drills, or disintegrating any other hardened material.  
**One 12" molybdenum electrode removes 35 to 40 broken taps.**

### **ELECTRO ARC MANUFACTURING COMPANY**

161 Enterprise Drive, Ann Arbor, MI 48103  
Phone: (734) 761-5400 • (800) 521-0423  
• Fax: (734) 761-5426  
• E-mail: sales@electroarc.com

### **ELECTRO ARC COMPANY LTD.**

The Wallows Industrial Estate  
• Fens Pool Avenue  
Brierley Hill, West Midlands DY5 1QA  
Telephone: (01384) 263426 • Facsimile (01384) 79017  
e-mail: sales@electroarc.co.uk